

234 November 23-1888

Survey of Lithographic Stone Quarry in North End of Ogden Valley for Chas. Blackwell, T. Hactley, C. Dank & others

Variation $17^{\circ}30'E$

NE $\frac{1}{4}$ and S.E. $\frac{1}{4}$ Sec 35 } T-8 N. R-1-W,
NW $\frac{1}{4}$ " S.W. $\frac{1}{4}$ " 36 }

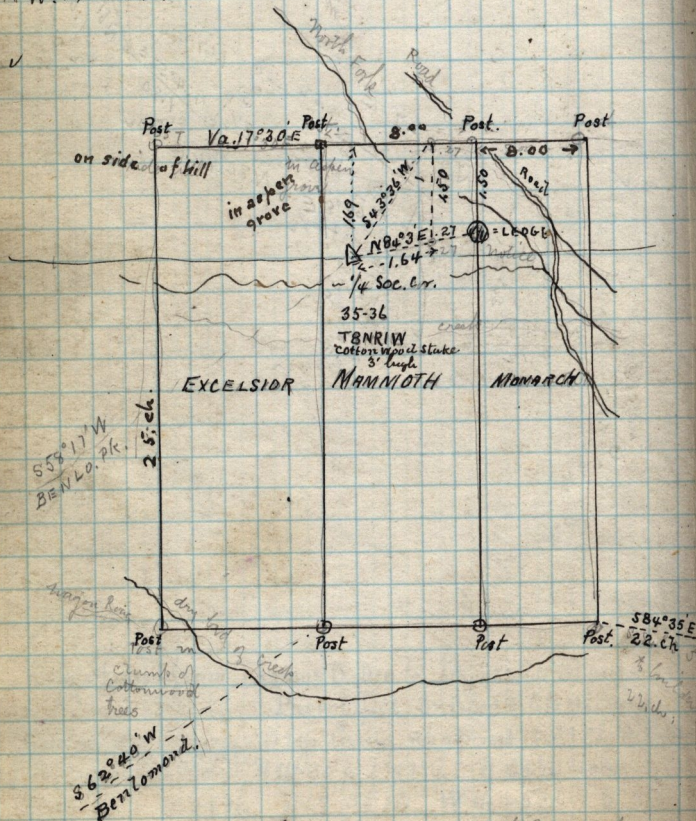

Mammoth logs 1.69 ch N. + 1.90 ch E. of S.W. cor

T-8 N. R-1-W Sec 36 T-8 N. R-1-W